



Installation Manual

P/N 1-301-1706-01 (N54 Coil-Pack Conversion Kit)

E9X/E8X/E6X CHASIS VEHICLES

(With N54 Motors)



This installation is not recommended for a novice or the new guy in the shop. Use caution when installing not to damage any factory components or components included in this kit. If you are not experienced in working on cars we recommend taking this kit to your local BMW Performance shop for installation.

Note: Precision Raceworks holds no responsibility for any damage that occurs or laws that are broken in the installation or use of this kit. This kit is intended for off road purposes only.

Precision Raceworks LLC

Houston Texas 77084

<http://www.precisionraceworks.com>

Sales@PrecisionRaceworks.com

©Precision Raceworks

Precision Raceworks N54 Ignition Kit Package Contents

Qty	Description
6	Ignition Coil PN 1-601-01-5060
6	Wire adapters
12	Stainless Carriage bolts
12	Stainless 10mm Nuts
1	Section of 3:1 Ratio heat shrink
1	Mounting Bracket
3	Loom mounting clips
10	Nylon zip ties
1	Section 3/8" Automotive Wire Loom
1	Section 1/2" Automotive Wire Loom

This section of the manual is intended to show the assembly of the **Precision Raceworks N54 Ignition Kit** P/N 1-301-1706-01. For instructions of the removal or installation of the factory coils please refer to your service manual or instructions found elsewhere.

(Instructions can also be found on the internet multiple places such as [this video here](#))

1. Remove the two E10 screws (8mm 12pt socket can be used) holding down the plastic wire isolator.
2. Using a small flat blade screwdriver or pick tool release each of the clips holding the two half's of the plastic wire isolator together, then remove and discard the plastic wire isolator.

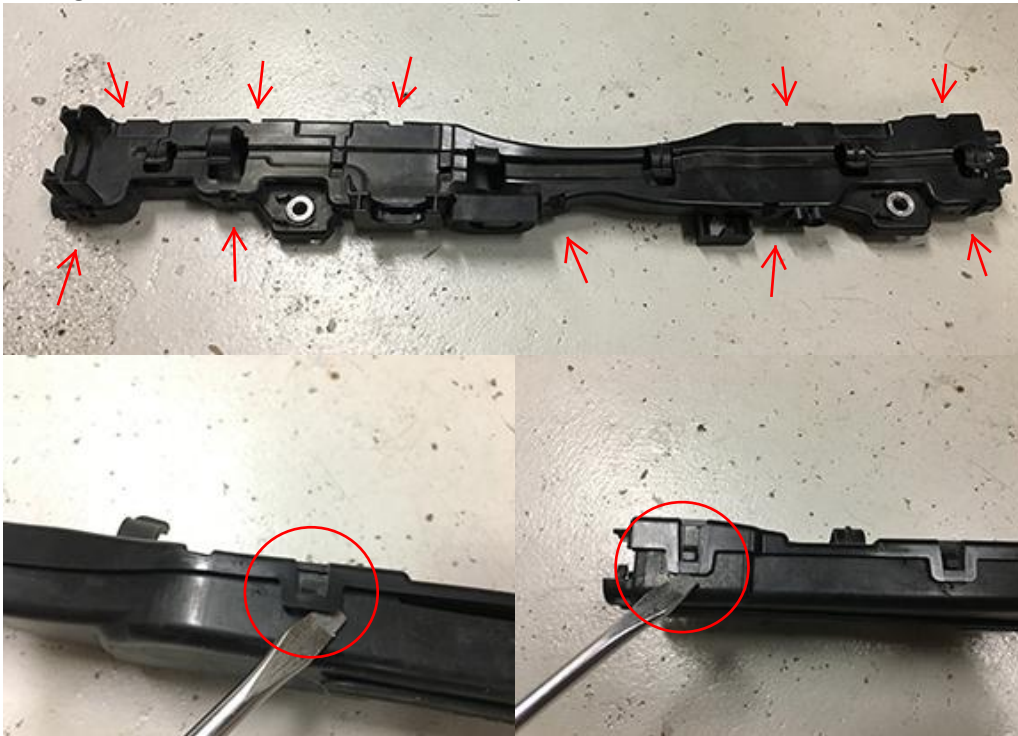

3. Using a small flat blade screw driver remove the terminal lock through the side of each of the factory coil connectors ([Video of the complete Depin process can be found here](#))

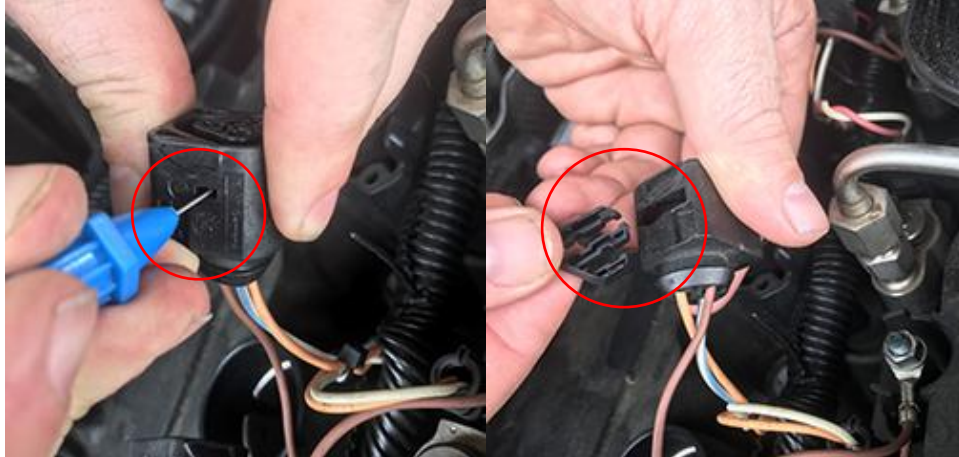

4. Using a depin tool (a small paperclip works too in a pinch) remove each of the 3 terminals pulling them out the back of the connector, **pull firmly to remove wire** (repeat for all 6 connectors)

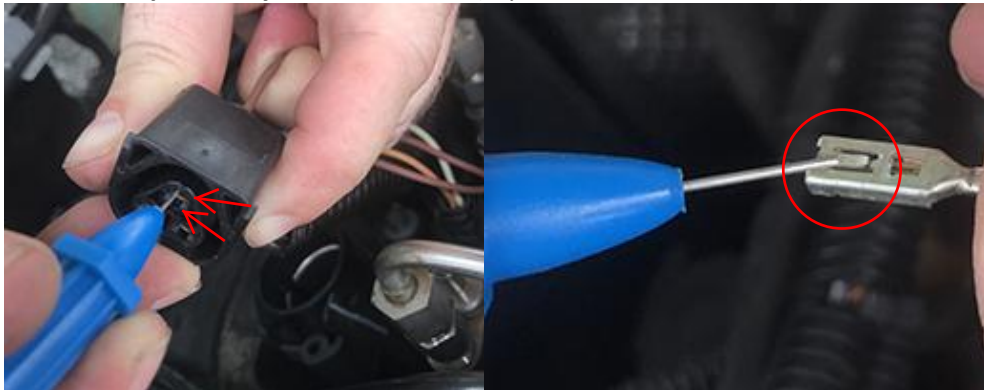

5. Work on one terminal at a time matching colors, inserting the mate terminal, and heat shrink using the provided heat shrink until all terminals have been completed (Cut heat shrink as necessary).



6. Using the provided smaller automotive wire loom (3/8" loom) and the nylon zip ties provided loom the ignition and injector wires cutting loom as needed. Using the provided larger automotive wire loom (1/2" loom) and the nylon zip ties provided loom the remaining wires cutting loom as needed

7. Install each of the provided spark plug wires pushing firmly on the top of each to ensure properly seated



8. Assemble and install the ignition coil rail as shown below securing it with the two previously removed E10 screws (DO NOT OVER TIGHTEN THEY ARE ALUMINUM)



9. Route & Secure the wire loom as illustrated below using the loom clips included, connecting each of the plug wires and ignition coil wires.

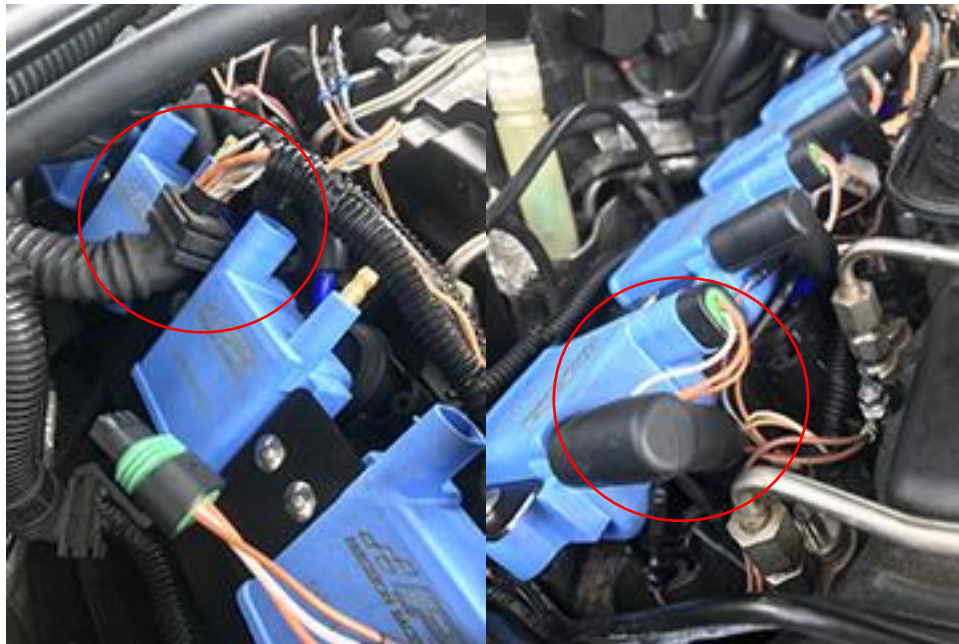

10. Reinstall the engine cover and assemble the rest of the panels removed in the reverse order of which each was installed

12 Month Limited Warranty

Precision Raceworks, LLC warrants to the consumer that all Precision Raceworks products will be free from defects in material and workmanship for a period of twelve (12) months from date of the original purchase. Products that fail within this 12 month warranty period will be repaired or replaced at Precision Raceworks discretion, when determined by Precision Raceworks that the product failed due to defects in material or workmanship.

This warranty is limited to only the repair or replacement of the Precision Raceworks part. In no event shall this warranty exceed the original purchase price of the Precision Raceworks part nor shall Precision Raceworks be responsible for special, incidental or consequential damages or cost incurred due to the failure of this product.

Warranty claims to Precision Raceworks must be transportation prepaid and accompanied with dated proof of purchase. This warranty applies only to the original purchaser of product and is non-transferable. All implied warranties shall be limited in duration to the said 12 month warranty period. Improper use or installation, accident, abuse, unauthorized repairs or alterations voids this warranty.

An Precision Raceworks Warranty Claim Form Must Accompany All Warranty Claims. Products returned to Precision Raceworks with no Return Goods Authorization and or No Warranty Claim Form may be rejected and returned to sender. Precision Raceworks disclaims any liability for consequential damages due to breach of any written or implied warranty on all products manufactured by Precision Raceworks. Warranty returns will only be accepted by Precision Raceworks when accompanied by a valid Return Goods Authorization (RGA) number. Credit for defective products will be issued pending inspection. Product must be received by Precision Raceworks within 30 days of the date RGA was issued.

Please note that before we can issue an RGA for any product, it is first necessary for the installer or end user to contact us at Warranty@PrecisionRaceworks.com to discuss the problem. Most issues can be solved through email or over the phone. Under no circumstances should a product be returned or RGA requested before the above process transpires.

A PRECISION RACEWORKS WARRANTY CLAIM FORM MUST ACCOMPANY ALL ELECTRONICS WARRANTY CLAIMS. Precision Raceworks Products returned to Precision Raceworks with no RGA and or No Warranty Claim Form may be rejected and returned to sender.

A copy of the Precision Raceworks Warranty Claim Form can be obtained by sending a request for the form to Warranty@PrecisionRaceworks.com .